

Lever switch, 8 positions.

Applications

The lever switch (8 positions) is suitable for various applications.

Part No.

44-800.8

Mechanical characteristics

- Mounting
Ø 22.5 mm, raised
- 2 axes
- Soft cross guidance, pulse
- 12° deflection angle
- Mechanical service life
up to 1.2 million switching cycles
- Connection
soldering terminal

Electrical characteristics

- Operating voltage
250 VAC
- Output signal
5A/4 NC + 4 NO
- Contact material
gold-plated silver alloy

Ambient conditions

- Operating temperature
-30 °C to +80 °C
- Storage temperature
-40 °C to +85 °C

Degree of protection

- IP65 front protection
- IP20, IP40 rear protection

A choice of three lever switches can be found at eao.com/products.



Mounting cut-outs

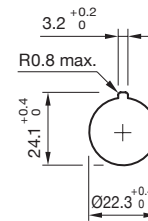

Wiring diagram

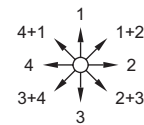

Dimensions

