

Indicator 8 mm LED 5 mm, IP 67

Equipment consisting of (schematic overview)

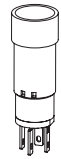

Indicator



Retaining ring



Fixing nut

Each Part Number listed below includes all the black components shown in the 3D-drawing.

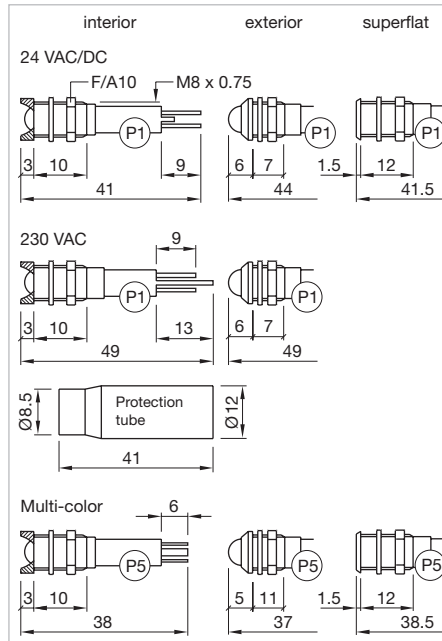

Dimensions [mm]
 P1 = Plug-in terminal 2.8 x 0.8 mm,
 P5 = Plug-in terminal 2.0 x 0.5 mm

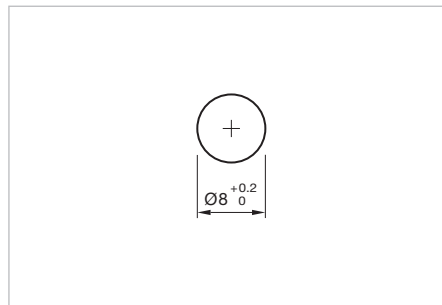

Mounting cut-outs [mm]



Product can differ from the current configuration.

Additional Information

- Connectors: Brass terminal = anode (+); brass tinned terminal = cathode (-)
- Operating voltage tolerance +10 %
- Operating current tolerance ±15 %

Product attribute	Reflector	LED colour	Operating voltage	Operation current	Lumi. intensity	Terminal	Part No.	Component layout	Weight
 <p>Indicator 8 mm LED 5 mm, Front dimension Ø 9.5 mm</p>	Metal satin-chrome, interior	red	24 VDC	20 mA	80 mcd	Plug 2.8 x 0.8 mm	17-050350		0.005 kg
			24 VAC	19 mA	76 mcd	Plug 2.8 x 0.8 mm	17-050360		0.005 kg
		green	24 VDC	20 mA	32 mcd	Plug 2.8 x 0.8 mm	17-050351		0.005 kg
			24 VAC	20 mA	30 mcd	Plug 2.8 x 0.8 mm	17-050361		0.005 kg
		yellow	24 VDC	20 mA	32 mcd	Plug 2.8 x 0.8 mm	17-050352		0.005 kg
			24 VAC	19 mA	30 mcd	Plug 2.8 x 0.8 mm	17-050362		0.005 kg
		blue	24 VDC	20 mA	60 mcd	Plug 2.8 x 0.8 mm	17-050357		0.005 kg
			24 VAC	19 mA	57 mcd	Plug 2.8 x 0.8 mm	17-050367		0.005 kg
		red/green	24 VDC	22 mA	11/30 mcd	Plug 2.0 x 0.5 mm	17-130354	1	0.005 kg
		red/yellow	24 VDC	22 mA	10/11 mcd	Plug 2.0 x 0.5 mm	17-130355	2	0.005 kg
		green/yellow	24 VDC	22 mA	20/15 mcd	Plug 2.0 x 0.5 mm	17-130356	3	0.005 kg

17 Raised design

Product attribute	Reflector	LED colour	Operating voltage	Operation current	Lumi. intensity	Terminal	Part No.	Component layout	Weight
 <p>Indicator 8 mm LED 5 mm, Front dimension Ø 9.5 mm</p>									
Sunlight visibility, light reduction of around 25 % by use of AC	Metal satin-chrome, interior	red	24 VAC/DC	9/17 mA	1200 mcd	Plug 2.8 x 0.8 mm	17-090350		0.005 kg
		yellow	24 VAC/DC	9/17 mA	1100 mcd	Plug 2.8 x 0.8 mm	17-090352		0.005 kg
		green	24 VAC/DC	9/17 mA	1300 mcd	Plug 2.8 x 0.8 mm	17-090355		0.005 kg
		blue	24 VAC/DC	9/17 mA	600 mcd	Plug 2.8 x 0.8 mm	17-090357		0.005 kg
		white	24 VAC/DC	9/17 mA	1000 mcd	Plug 2.8 x 0.8 mm	17-09035W		0.005 kg
with protection tube	Metal satin-chrome, interior	red	230 VAC	3 mA	22 mcd	Plug 2.8 x 0.8 mm	17-500430		0.005 kg
		green	230 VAC	3 mA	5 mcd	Plug 2.8 x 0.8 mm	17-500431		0.005 kg
		yellow	230 VAC	3 mA	7 mcd	Plug 2.8 x 0.8 mm	17-500432		0.005 kg
	Metal black-chrome, interior	red	24 VDC	20 mA	80 mcd	Plug 2.8 x 0.8 mm	17-051350		0.005 kg
		green	24 VDC	20 mA	32 mcd	Plug 2.8 x 0.8 mm	17-051351		0.005 kg
		yellow	24 VDC	20 mA	32 mcd	Plug 2.8 x 0.8 mm	17-051352		0.005 kg
		blue	24 VDC	20 mA	60 mcd	Plug 2.8 x 0.8 mm	17-051357		0.005 kg
 <p>Indicator 8 mm LED 5 mm, Front dimension Ø 9.5 mm</p>									
	Metal satin-chrome, exterior	red	24 VDC	20 mA	80 mcd	Plug 2.8 x 0.8 mm	17-040350		0.005 kg
			24 VAC	19 mA	76 mcd	Plug 2.8 x 0.8 mm	17-040360		0.005 kg
		green	24 VDC	20 mA	32 mcd	Plug 2.8 x 0.8 mm	17-040351		0.005 kg
			24 VAC	19 mA	30 mcd	Plug 2.8 x 0.8 mm	17-040361		0.005 kg
		yellow	24 VDC	20 mA	32 mcd	Plug 2.8 x 0.8 mm	17-040352		0.005 kg
			24 VAC	19 mA	30 mcd	Plug 2.8 x 0.8 mm	17-040362		0.005 kg
		blue	24 VDC	20 mA	60 mcd	Plug 2.8 x 0.8 mm	17-040357		0.005 kg
			24 VAC	19 mA	57 mcd	Plug 2.8 x 0.8 mm	17-040367		0.005 kg
		red/green	24 VDC	22 mA	11/30 mcd	Plug 2.0 x 0.5 mm	17-120354	1	0.005 kg
		red/yellow	24 VDC	22 mA	10/11 mcd	Plug 2.0 x 0.5 mm	17-120355	2	0.005 kg
green/yellow	24 VDC	22 mA	20/15 mcd	Plug 2.0 x 0.5 mm	17-120356	3	0.005 kg		
Sunlight visibility, light reduction of around 25 % by use of AC	Metal satin-chrome, exterior	red	24 VAC/DC	9/17 mA	1200 mcd	Plug 2.8 x 0.8 mm	17-080350		0.005 kg
		yellow	24 VAC/DC	9/17 mA	1100 mcd	Plug 2.8 x 0.8 mm	17-080352		0.005 kg
		green	24 VAC/DC	9/17 mA	1300 mcd	Plug 2.8 x 0.8 mm	17-080355		0.005 kg
		blue	24 VAC/DC	9/17 mA	600 mcd	Plug 2.8 x 0.8 mm	17-080357		0.005 kg
		white	24 VAC/DC	9/17 mA	1000 mcd	Plug 2.8 x 0.8 mm	17-08035W		0.005 kg
with protection tube	Metal satin-chrome, exterior	red	230 VAC	3 mA	22 mcd	Plug 2.8 x 0.8 mm	17-510430		0.006 kg
		green	230 VAC	3 mA	5 mcd	Plug 2.8 x 0.8 mm	17-510431		0.006 kg
		yellow	230 VAC	3 mA	7 mcd	Plug 2.8 x 0.8 mm	17-510432		0.006 kg
	Metal black-chrome, exterior	red	24 VDC	20 mA	80 mcd	Plug 2.8 x 0.8 mm	17-041350		0.005 kg
		green	24 VDC	20 mA	32 mcd	Plug 2.8 x 0.8 mm	17-041351		0.005 kg
		yellow	24 VDC	20 mA	32 mcd	Plug 2.8 x 0.8 mm	17-041352		0.005 kg
		blue	24 VDC	20 mA	60 mcd	Plug 2.8 x 0.8 mm	17-041357		0.005 kg
 <p>Indicator 8 mm LED 5 mm, Front dimension Ø 9.5 mm</p>									
	Metal satin-chrome, superflat	red	24 VDC	20 mA	13 mcd	Plug 2.8 x 0.8 mm	17-010350		0.005 kg
		green	24 VDC	20 mA	8 mcd	Plug 2.8 x 0.8 mm	17-010351		0.005 kg
		yellow	24 VDC	20 mA	8 mcd	Plug 2.8 x 0.8 mm	17-010352		0.005 kg
		red/green/yellow	24 VDC	15/15/3 mA	3/3/6 mcd	Plug 2.0 x 0.5 mm	17-100354	1	0.005 kg

The component layouts you will find from page 15

Indicator flush mount 8 mm LED 5 mm, IP 40

Equipment consisting of (schematic overview)

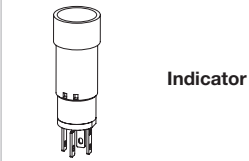

Indicator

Each Part Number listed below includes all the black components shown in the 3D-drawing.

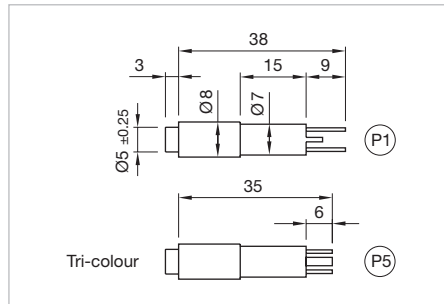

Dimensions [mm]
 P1 = Plug-in terminal 2.8 x 0.8 mm,
 P5 = Plug-in terminal 2.0 x 0.5 mm



Product can differ from the current configuration.

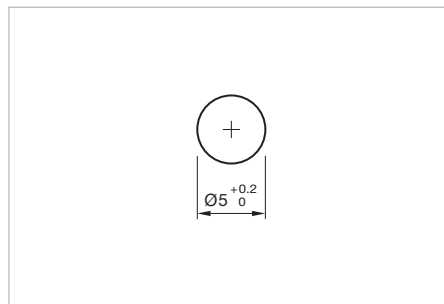

Mounting cut-outs [mm]

Additional Information



- Connectors: Brass terminal = anode (+); brass tinned terminal = cathode (-)
- Operating voltage tolerance +10 %
- Operating current tolerance ±15 % • The mounting is performed by cementing the LED Indicator using a solvent free two element epoxy-based adhesive
- Operation modes (tri-colour LED): Red, green or yellow. Both diodes produce yellow as a mixed colour

Product attribute	LED colour	Operating voltage	Operation current	Lumi. intensity	Terminal	Part No.	Component layout	Weight
 <p>Indicator flush mount 8 mm LED 5 mm, Front dimension Ø 5 mm</p>	red	24 VDC	22 mA	11 mcd	Plug 2.8 x 0.8mm	17-590350		0.002 kg
	green	24 VDC	22 mA	10 mcd	Plug 2.8 x 0.8mm	17-590351		0.002 kg
	yellow	24 VDC	22 mA	9 mcd	Plug 2.8 x 0.8mm	17-590352		0.002 kg
	Tri-colour LED	rot/grün/gelb	24 VDC	15/15/30 mA	3/3/6 mcd	Plug 2.0 x 0.5 mm	17-590354	1



The component layouts you will find from page 15

Backside

Flat receptacle

Product attribute	Part No.	Weight
 <p>Flat receptacle</p>		
2.0 x 0.5 mm plug-in terminal	31-945	0.001 kg
 <p>Flat receptacle</p>		
2.8 x 0.8 mm plug-in terminal	84-9420	0.001 kg

Insulation sleeve

Product attribute	Part No.	Weight
 <p>Insulation sleeve</p>		
for flat receptacle 2.0 mm	31-928	0.001 kg
 <p>Insulation sleeve</p>		
for flat receptacle 2.8 mm	31-929	0.001 kg



17 Accessories

Mounting

Fixing nut long

Dimension	Part No.	Weight
 <p>Fixing nut long</p>		
Ø 9/M8 x 13 mm	19-991	0.001 kg

Mounting tool

Produkteigenschaften	Part No.	Weight
 <p>Mounting tool</p>		
	01-907	0.02 kg
 <p>Mounting tool</p>		
for fixing nut long Part No. 19-991	19-905	0.011 kg

Drawings

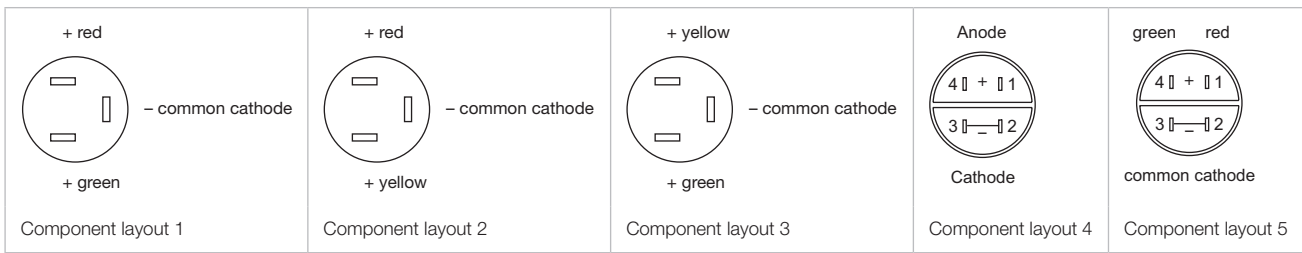

17 Technical data

Technical Data

Material

Actuator

Reflector: Brass satin chrome/black chrome
for indicator 16 mm dia. in black plastic
The plastic (polycarbonate) is limited resistant against chemicals

Mechanical characteristics

Terminals

Plug-in terminal 2.0 x 0.5 mm or 2.8 x 0.8 mm
The indicators with tab-connection are not qualified for soldering

Tightening torque

20 Ncm

Electrical characteristics

Polarity

Anode (+) Brass plug-in connector
Cathode (-) Brass tinned plug-in connector

Operating voltage tolerance

+10 %

Operating current tolerance

±15 %

Optical characteristics

Wave length

red	660 nm
super red	625 nm
hyper red	660 nm
orange	625 nm (for execution 230V: 610 nm)
green	565 nm
yellow/green	570 nm (for execution 230V: 575 nm)
yellow	590 nm
blue	475 nm
red/green	660/565 nm
red/yellow	660/590 nm

Environmental conditions

Storage temperature

-25 °C ... +80 °C

Service temperature

-20 °C ... +60 °C

Protection degree

front IP 40
IP 67 as per DIN EN 60529 - Gap between LED and reflector and gap between reflector and frontplate sealed to IP 67 when using the supplied gasket

Approvals

Approbations

UL
VDE

EAO reserves the right to alter specifications without further notice.