



EAO, the pioneer of illuminated pushbuttons and the expert for innovative, reliable and intuitive human machine interfaces (HMIs) has expanded its Series 57 range to include an emergency-call button.

The emergency-call button with its raised bell symbol (conforming to TSI PRM & ADA) serves to call for assistance in public transport toilet facilities, in public buildings or at emergency terminals.

The emergency-call button combines functionality and design. Two feedback rings illuminate when the button is activated. The robust anodized aluminium front ring protects the button against damage and avoids accidental actuation. The front is protected to IP69K and makes the emergency-call button ideal for outdoor use or applications in harsh environments. It shares the same design and dimensions as other products of the Series 57 range.

The extra-large operating area enables a simple and safe operation in all situations.

The tool-less final mounting saves time and money. The Series 57 is the perfect choice for all train and tram manufacturers and operators.

Materials

The materials used meet EAO's stringent standards of quality, functional reliability, service life and design. They are resistant against aggressive cleaning chemicals and against UV exposure.

Mechanical properties

- 6-strand cable with core end-sleeves (wire cross-section 0.5 mm² or 0.24 mm²)
- Cable length: 200 mm; 1000 mm; 2000 mm (other lengths on request)

- Mechanical lifetime: 2 Million operations
- Resists shock and vibration
- Plug-in connector on request
- Actuating force: < 15 N

Electrical properties

- Operating voltage 16 – 63 VDC (min./max.)

Switching element

- Electronic high side switch

Typical applications

- Toilets (WCs)
- Public transport
- Public buildings
- Emergency terminals

Environmental conditions

- Storage temperature –45°C to +90°C
- Operating temperature –40°C to +85°C

Degree of protection

- IP69K front

Symbols conform to TSI PRM & ADA



Plastic

Aluminium

Feedback ring illumination

- Outer ring: yellow LEDs
- Inner ring: yellow LEDs

Colour of bezel

- Metal: Aluminium red anodized

Colour of symbol inserts

- Plastic: Red RAL 3000
- Metal: Aluminium red anodized

Colour of symbol

- Plastic: White
- Metal: Black

Dimensions

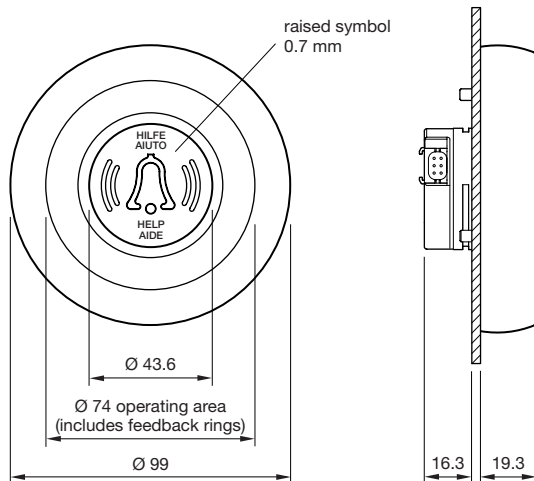

Standards and guidelines

- Units compliant to
 - EN 60947-5-1
 - EN 50155, part EMV
 - EN 14752

- Fire protection norms
 - NFF 16-101/NFF 16-102/NFF 31-054
 - DIN 5510-2/DIN 5510-5
- Cables according to
 - DIN EN 50306-2; VDE 0260-306-2
 - DIN EN 50306-4; VDE 0260-306-4
 - NFF 63808/NFF 61030
- Symbols
 - TSI PRM & ADA

Mounting/exchange

The mounting dimensions of the Series 57 are identical to the dimensions of other manufacturers. This is why a one-to-one upgrade to Series 57 is easily performed at any time.

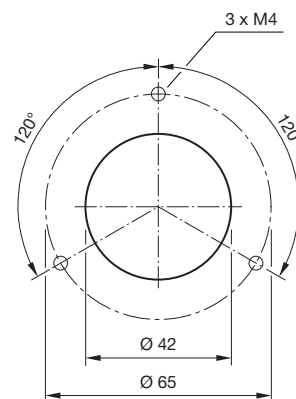

Wiring diagram

Dual ring illumination, individually controllable

VDC = 16 - 63 VDC

